

Sport Sway Bar Kit 22105 55-57 Chevy "Tri-Five"



*Thank you for your purchase from our new line of Chevy parts.
Please call us at 877 - 4NO - ROLL if you have any questions
regarding the service or installation of your Hotchkis Performance products.*

IMPORTANT: PLEASE READ THE ENTIRE INSTRUCTION MANUAL BEFORE STARTING THIS INSTALLATION. THERE'S A LOT OF HOLE DRILLING INVOLVED AND IT WOULD BE A SHAME TO MAKE ANY UNNECESSARY HOLES DUE TO INSTALLER ERROR.

Installation of Hotchkis Front Sway Bar

1F *Raising Vehicle*

Raise front of the vehicle by using a 4 post lift or drive-on ramps. Securely block the rear wheels of the vehicle. Do not remove the front wheels during installation for safety. It is imperative that the vehicle is at ride height for this installation.



2F *Drill Holes for the Bushing Brackets*

When looking at the front section of the chassis frame, there are 2 frame rails on each side that extend to the front bumper. The outer frame rail is the main support for the front bumper. The bushing brackets will be installed on the main outer frame rail, just behind where the 2 frame rails meet. This will require you to drill 2 holes per side. Use a silver marker to sketch out a line, depicting where the inner frame rail joins the outer rail.

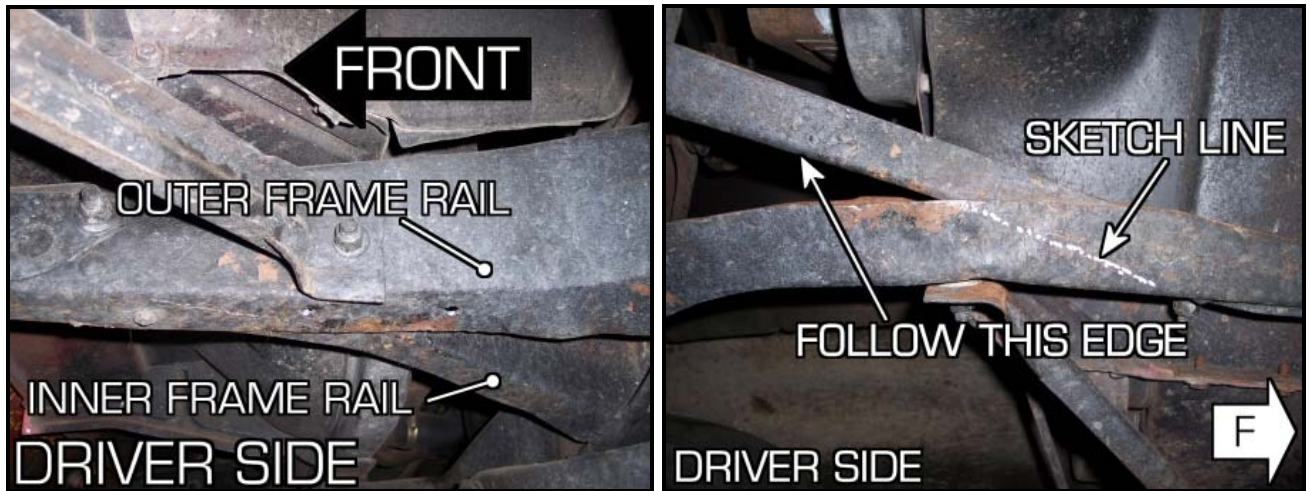

Your Hotchkis kit includes bushing bracket reinforcement plates, which will be installed on the inside of the frame rail. When measuring out where to drill the holes, your main goal is to position the holes as far forward without contacting the inner frame rails. See picture for more details. Make sure the 2 holes are parallel with the length of the car. Drill the holes using a 7/16" drill bit. Remember to always wear safety glasses when drilling.

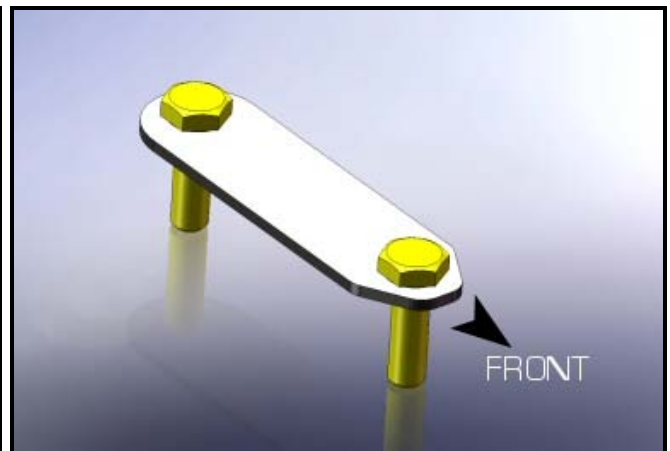
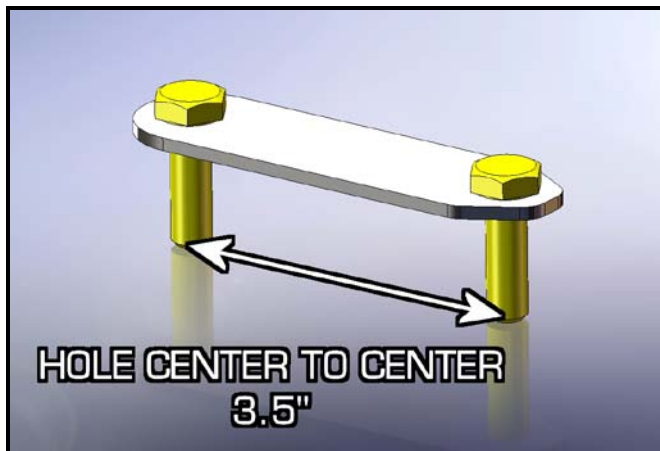

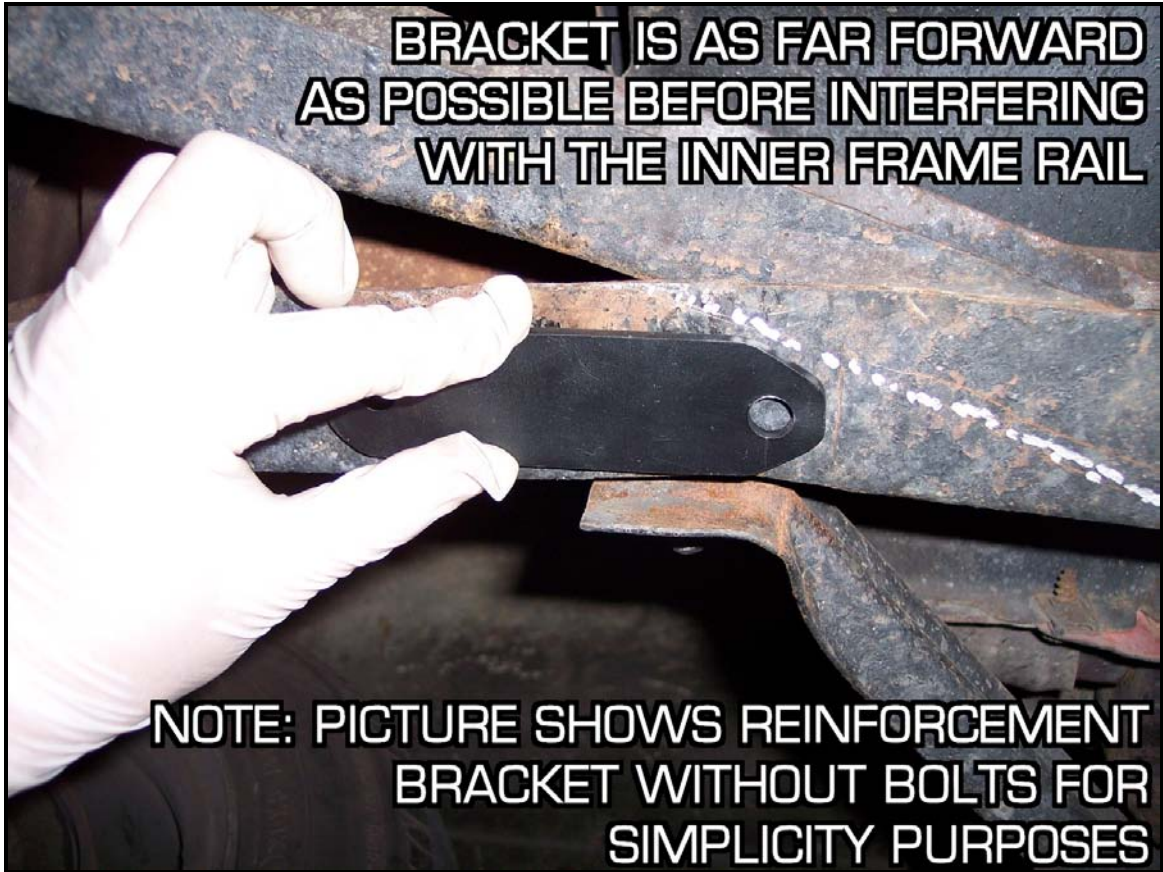

Once the holes are drilled out, undo the nut & bolt that holds the bumper support to the frame rail. This will give you enough clearance to install the reinforcement plate inside the frame rail. Install both reinforcement plates and re-install the bumper support nut & bolt.

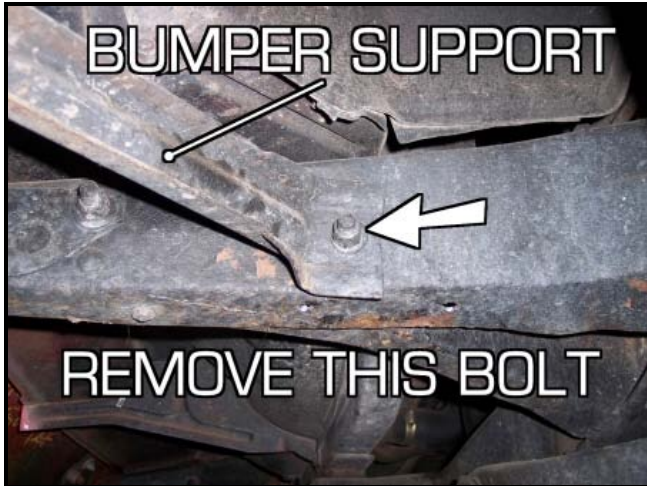

3F *Install the Bushing Brackets*

With the holes drilled out and reinforcement plates in position, you are now ready to install the bushing brackets. Apply the supplied silicon grease on the inside of each bushing. Install the bushings onto the sway bar. Place the bushing bracket onto the bushing. Hold the bar up to the chassis and slide the reinforcement plate studs into the bushing bracket holes. Install the supplied nuts to the studs. You may fully tighten these nuts.



4F *Drill Holes for the End Link Brackets*

Install the end links as shown in the picture. Position the sway bar so that the end link bracket is located on the lower control arm properly. Important note: Make sure the sway bar is centered with the car. A good way to measure this is to look at the gap between the sway bar ends and the frame on each side.



Mark the hole centers on the lower control arm with a marker. Once the holes are marked, you can disassemble the end links from the bar.

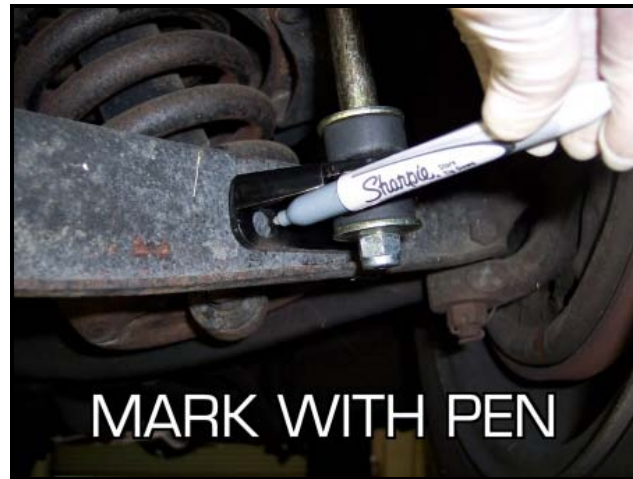

Drill the holes using a 3/8" drill bit. Remember to always wear safety glasses when drilling.



Install the end link bracket onto the lower control arm with the supplied bolts.



Reassemble the end links. Tighten the end links until you start to see the bushings begin to bulge.



5F *Double-Check for Tightness*

Make sure to double-check all fasteners. You are now finished with the front sway bar installation.



6F *Sway Bar Stiffness*

This bar has a stiffness rate of approx. 800 lbs/in.

Installation of Hotchkis Rear Sway Bar

1R *Raising Car*

Raise rear of the vehicle by using a 4 post lift or drive-on ramps. Securely block the front wheels of the vehicle. Do not remove the rear wheels during installation for safety. It is imperative that the vehicle is at ride height for this installation.

2R *Install U-Bolts (kit#T1722) on Rear Axle*

Take the washers and nuts off of the U-bolts and slide them on top of the axle tubes on each side. They should be centered and approx. 27" apart from each other. If you have any brake lines in the way, you must relocate them. This could be as easy as unclipping them and bending them away from the axle tubes. Apply the supplied anti-seize to the threads of the U-bolts.



3R *Prepare the Rear Sway Bar*

Next, we are going to put all of the components on the sway bar before we install it on the car. Grease the inside surface of the bushings with the supplied silicon lube. Install them on the sway bar along with the bushing brackets.

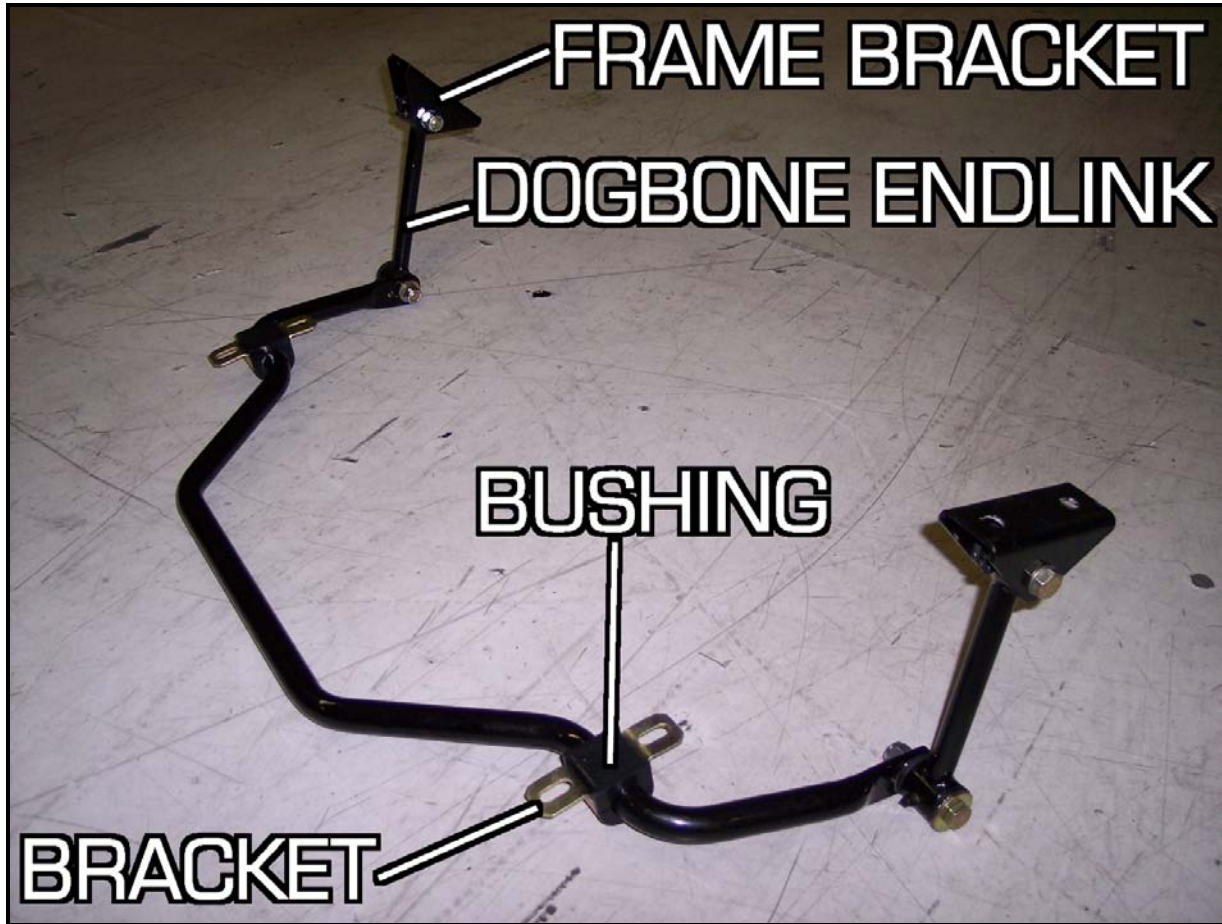

You will also need to grease the outside surface of the dogbone end link bushings. Install the end link onto the sway bar ends as shown in the picture. Use the hole closest to the end for installation purposes. Next, install the frame bracket onto the other end of the end link. The bolts do not need to be fully tight at this time, but they should be snug.



End Link Hardware Order:

1/2" Bolt - Lg.Washer - Dog Bone End Link - Sway bar - Sm.Washer -Nut



4R *Mount the Sway Bar onto the Rear Axle*

Now we are going to bring the assemble sway bar to the rear axle. Also grab the axle brackets at the same time. These will have to go on between the axle and the bushing bracket. See picture for more details. When tightening the u-bolt nuts, make sure the u-bolt is pointing straight down. I.e. The u-bolt should not be at an angle with the ground.

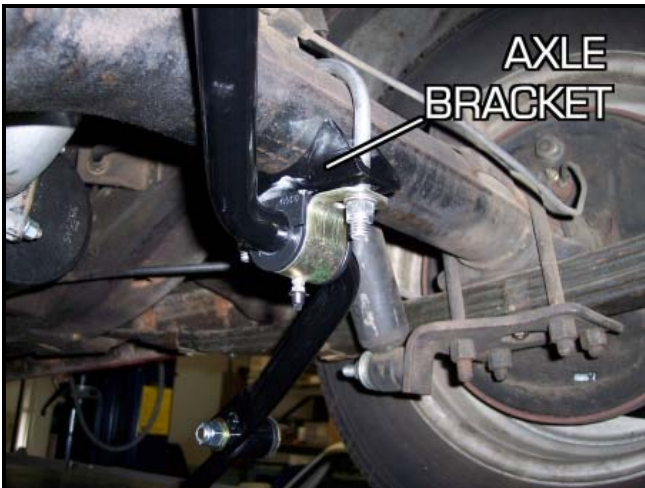

5R *Drill Holes for the Frame Brackets*

You're going to be drilling 2 holes for the frame brackets on each side. But first we need to know where to drill the holes. Rotate the sway bar up to it's normal position. Make sure the sway bar is centered with the car. Next, position the end link so that it is slightly tilting towards the back of the car. The reason for tilting it back is so you can use either sway bar hole and the end link can stay fairly vertical in both positions. Make sure the frame bracket has it's flat side facing the frame. Mark the hole centers with a silver pen. Push the end links out of the way and drill out the 2 holes with a 7/16" bit. Remember to always wear safety glasses when drilling.



6R *Install Shorty U-Bolts (kit #1718) onto Frame*

Carefully insert the shorty U-bolt into one of your frame bracket holes you just drilled. Rotate the U-bolt down so that it pokes out through the second hole. It might be a good idea to spin on a nut temporarily on one end when doing this.



7R *Bolt the Frame Brackets to the Frame*

Now that you have the shorty U-bolts are in place you can bolt up the frame bracket to the frame. To make things easier, unbolt the frame bracket from the end link before you fasten the bracket to the frame. This will allow you to get to nuts easier.



8R *Double Check Hardware*

Make sure all hardware is fully tightened before driving the vehicle. You are done with the installation. The vehicle does not require an alignment after this installation.



9R *Stiffness Adjustment*

Your Hotchkis rear bar has 2 adjustment holes, which allows you to change the sway bar stiffness harder or softer. The hole closest to the sway bar end is the softer setting, while the hole furthest from the end is the stiffest. The stiffness values are as follows:

Soft Setting: 310 lbs/in added

Stiff Setting: 385 lbs/in added

Hotchkis Performance LLC Return Policy & Limited Warranty

Effective December 1, 2010 all Hotchkis products must be registered to qualify for warranty at www.hotchkis.net or via the mail-in warranty card, included with the product, within 30 days of the original purchase date.

IMPORTANT: This warranty supersedes all other warranties included with this product.

Return Policy

We want you to be completely satisfied with your Hotchkis Performance product. For products, presenting signs of shipping damage please contact the freight carrier immediately. All our products are guaranteed to be free from manufacturer's defects. If your order arrives with a manufacture defect, please contact our Customer Service Department at (562) 907-7757. You will be assigned a Returned Goods Authorization Number (RGA). The package you return must show the RGA on the outside of the package, include the original invoice and be shipped prepaid to our facility. The product has to be unused and in its original packaging materials. Exchanges or refunds made after 30 days will be subject to a 20% restocking charge. **If you purchased your Hotchkis Performance product from an authorized dealer, you are still covered by this return policy. All returns however, should be made to your dealer, not to Hotchkis Performance directly.**

Limited Warranty

Hotchkis Performance offers a Limited Warranty against defects in materials and workmanship for the term of 36 months (3 years) from the date of purchase of this product. This Warranty only applies to the original retail purchaser who retains ownership of the vehicle on which the product was originally installed. If the product is determined to be defective, Hotchkis Performance will repair, replace or refund the purchase price of the defective product at Hotchkis Performance's sole discretion, which shall fully satisfy and discharge any and all warranty claims. Any repaired or replaced product will be returned to the sender excluding the cost of freight. **Products must be registered to qualify for warranty at www.hotchkis.net or via the mail-in warranty card, included with the product, within 30 days of the original purchase date.**

Exclusions from Warranty

Items offered but not manufactured by Hotchkis Performance are warranted according to the manufacturer's terms and are not covered by this limited warranty. Hotchkis Performance shall not be responsible for any labor, removal, installation, re-installation or maintenance costs. This warranty does not cover the cosmetic finish or plating of any product or any normal wear and tear to any product including, but not limited to bushings, brackets, end-links, hardware, steering components, shocks or springs. In addition, this warranty does not apply to any products that have been:

- Improperly installed or installed by someone other than a qualified, licensed auto mechanic experienced in the installation and removal of suspension products;
- Improperly serviced, misused, or modified, altered or subjected to abuse, negligence, accident or collision;
- Installed in any vehicle that has been modified;
- Installed on any vehicle that has carried loads in excess of automobile manufacturer suggested weight limits; or
- Installed on any vehicle that has been subject to abnormal or excessive use, including rallying, racing, or racing-type activities or off-road use.

Limitation of Warranty

This limited warranty is the entire and only warranty for the products and may not be modified or supplemented by any other person or company in any form. Any description of the products, by anyone, is for the sole purpose of identifying them and is not part of the basis of the bargain, and does not constitute a warranty that the products will conform to that description. The statements of any salesperson do not constitute part of this limited warranty and cannot be relied upon as a warranty.

THERE ARE NO WARRANTIES, EXPRESSED OR IMPLIED, INCLUDING ANY IMPLIED WARRANTIES OF MERCHANTABILITY OR FITNESS FOR A PARTICULAR PURPOSE, WHICH EXTEND BEYOND THE DESCRIPTION ON THE FACE HEREOF. ANY IMPLIED WARRANTIES ARE DISCLAIMED TO THE FULLEST EXTENT PERMITTED BY LAW. THIS WARRANTY DOES NOT COVER CONSEQUENTIAL DAMAGES, LOSS OF TIME OR REVENUES, INCONVENIENCE, LOSS OF USE OF THE VEHICLE,



DAMAGE TO THE VEHICLE OR COMPONENTS OF THE VEHICLE, ANY OTHER TYPE OF CONSEQUENTIAL DAMAGES, OR OTHER INCIDENTAL OR INDIRECT DAMAGES. HOTCHKIS' MAXIMUM LIABILITY UNDER THIS WARRANTY SHALL IN NO EVENT EXCEED THE PURCHASE PRICE OF THE PRODUCT. Some states do not allow limitations on how long an implied warranty lasts or the exclusion or limitation of incidental or consequential damages and in such states the above limitations or exclusions may not apply. This limited warranty gives the purchaser specific legal rights and the purchaser may have other rights that may vary from state to state.

Technical Information

Hotchkis Performance makes every effort to ensure that you are provided with the most accurate and up-to-date technical information. However, all technical information is approximate and may vary upon application. Additional suspension components may be needed in some applications, depending upon the make, model, engine and chassis of the vehicle. Hotchkis Performance is not responsible for any consequences resulting from manufacturer's technical mid-year changes. Hotchkis Performance products should only be installed by a qualified, licensed auto mechanic experienced in the installation of such products.

Warranty Claim Procedure:

The answer to ALL the following questions should be YES before making a warranty claim:

- Did you register the product at www.hotchkis.net or via the mail-in warranty card within 30 days of purchase?
- Is the product appropriate to your application?
- Did you carefully and thoroughly read the instructions provided along with the product?
- Do you have the original invoice or sales receipt?
- Is the return date within 36 months from the purchase date?
- Are you the original purchaser?
- Was the product properly installed by a qualified, licensed auto mechanic?
- Has the product been installed on the original vehicle on which it was installed at all times?
- Is the product unmodified and clean?
- Is the reason for return a legitimate product defect?

If the answer to all these questions is YES, please contact our Customer Service Department at (562) 907-7757. You will be given a Returned Goods Authorization Number (RGA) valid for 60 days. You will also be asked to ship the product prepaid to our facility. All shipments MUST be (i) prepaid, (ii) include the original invoice or sales receipt, (iii) show the RGA on the outside of the package and (iv) include your name, address, make and model of the vehicle, and a brief description of the claimed defect, including the circumstances under which the defect occurred. If the warranty claim is deemed valid then Hotchkis will estimate shipping costs to return the repaired or replacement part and contact you for payment. Hotchkis's Limited warranty requires that any repaired or replaced product will be returned to the sender excluding the cost of freight. Warranty related inquiries should be sent to the following address:

**HOTCHKIS PERFORMANCE, LLC
C/O CUSTOMER SERVICE
8633 Sorensen Avenue
SANTA FE SPRINGS, CA 90670**

Hotchkis Performance will not accept product returns without the RGA number, receipt and the information described above. C.O.D. or collect shipments will be refused. Once the returns are received at Hotchkis Performance, we will evaluate the products, verify the sales receipt, and investigate the warranty claim. Any repaired or replaced product will be returned to the sender.

Effective December 1, 2010. This return policy and limited warranty supersedes all previous policy and warranty statements. Policies and warranties are subject to change without notice. Hotchkis Performance is not responsible for printing errors.