



## Installation Instructions

For Part Numbers:

- 250-315 700-469 Airaid Oiled Media Filter
- 251-315 701-469 SynthaMax Dry Media Filter - Red
- 252-315 702-469 SynthaMax Dry Media Filter - Black
- 253-315 703-469 SynthaMax Dry Media Filter - Blue

2014 Chevrolet SS  
6.2L V8

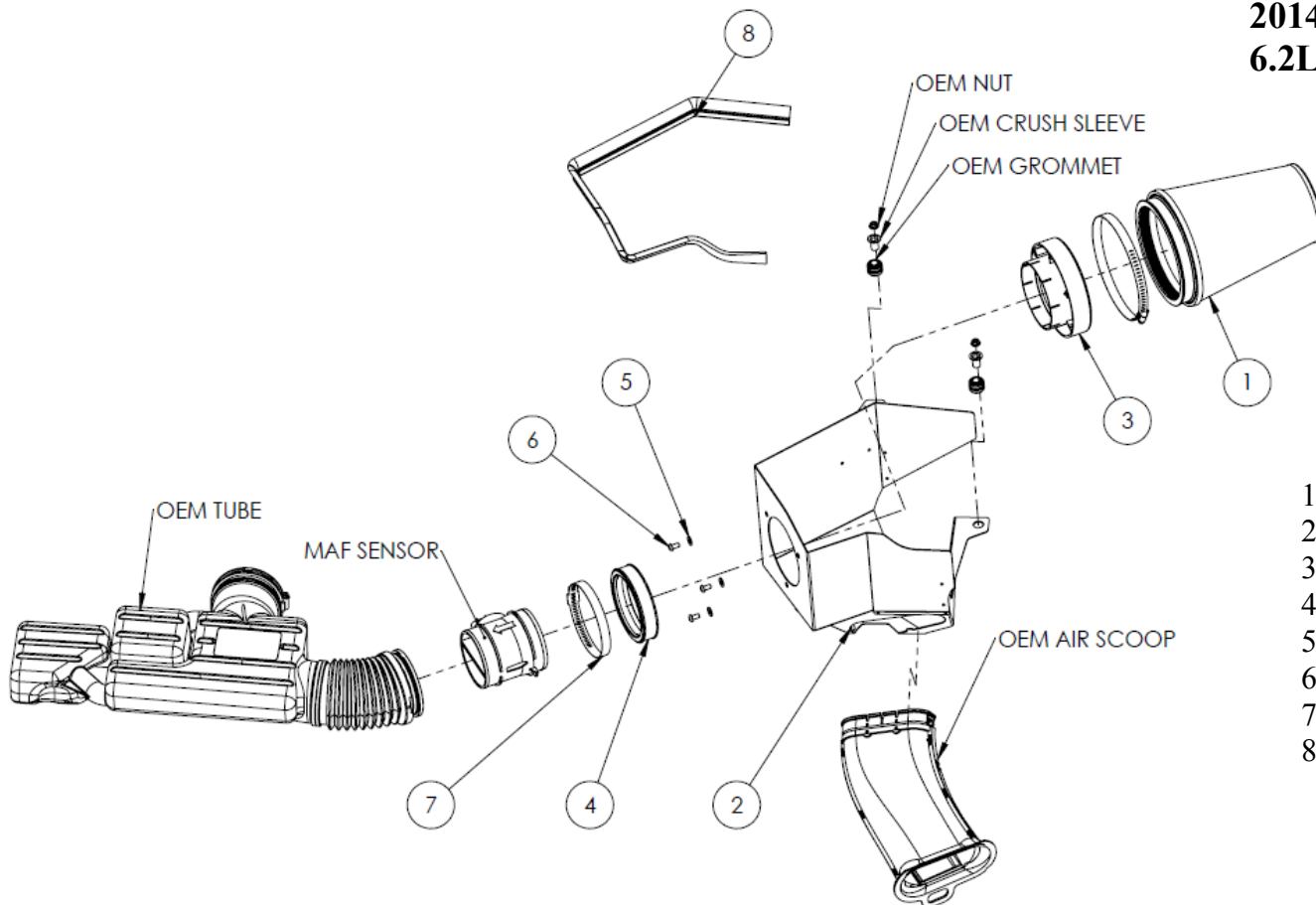

### Component Identification

1.	Airaid Premium Filter	1
2.	Cool Air Dam	1
3.	Filter Adapter	1
4.	Adapter Coupler	1
5.	1/4" Flat Washer	3
6.	1/4-20 x 1/2" Button Head Screw	3
7.	#68 Hose Clamp	1
8.	Weatherstrip 28 1/2"	1

Full color instructions can be viewed on our web site at [Airaid.com](http://Airaid.com). Use the **Product Search** function to find your part number, and click **View Details**.

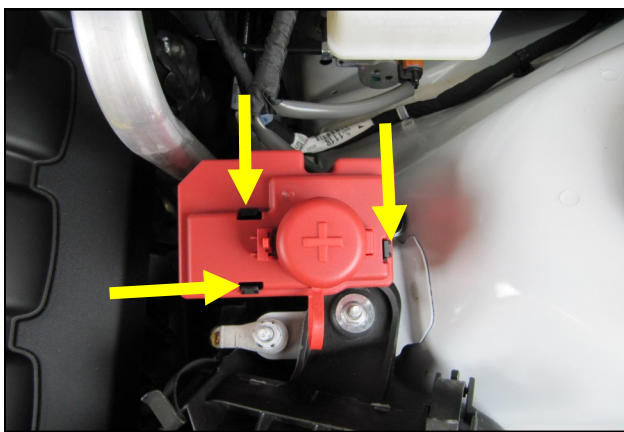

**1. Disconnect the negative battery terminal.** Depress the three locking tabs on the positive terminal cover and remove it.

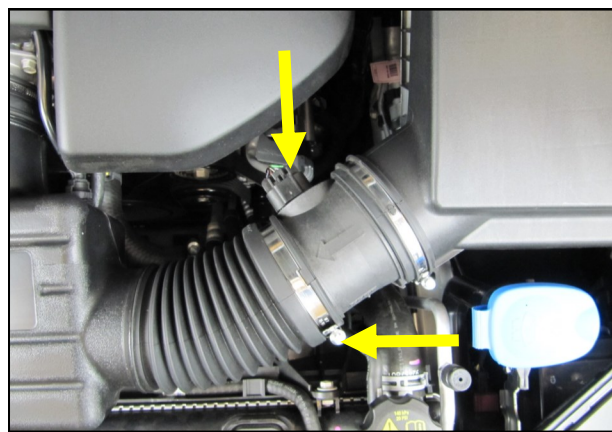

**2. Disconnect the Mass Air Flow sensor and loosen the intake tube clamp.**

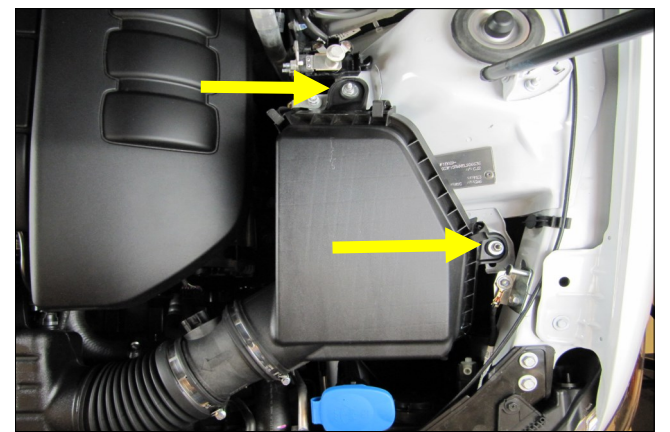

**3. Remove the two 6mm flange nuts securing the air box assembly to the inner fender.**



**4. Separate the intake tube from the Mass Air Flow sensor and remove the entire air box assembly from the vehicle.**

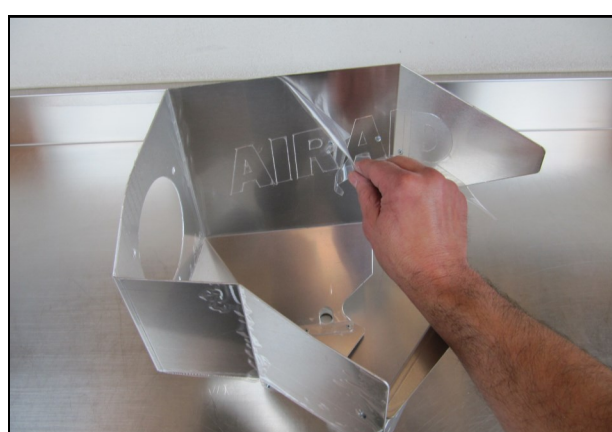

**5. Carefully remove the protective film from both sides of the Air Dam.**

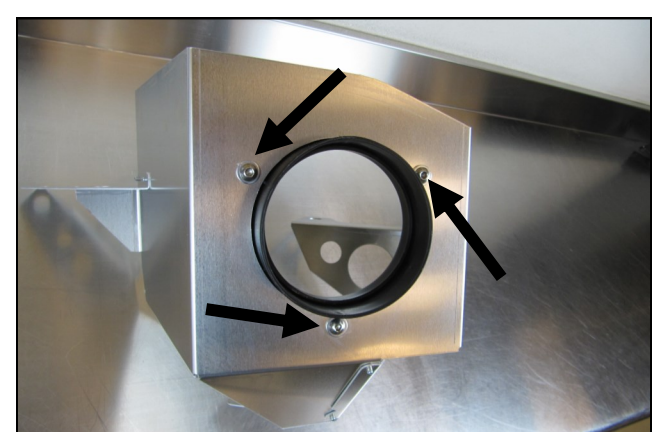

**6. Install the Filter Adapter onto the Air Dam as shown using the three Button Head Screws and Flat washers.**

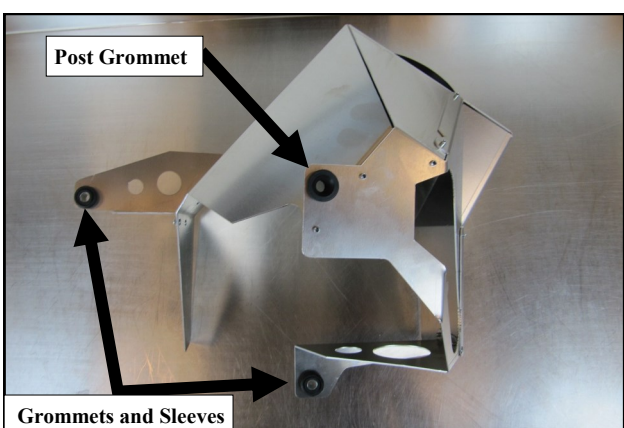

**7. Transfer the OEM grommets and steel sleeves from the factory air box, into the Air Dam assembly as shown. The grommets and steel sleeves are located on the upper half of the box and the post grommet in the lower half.**

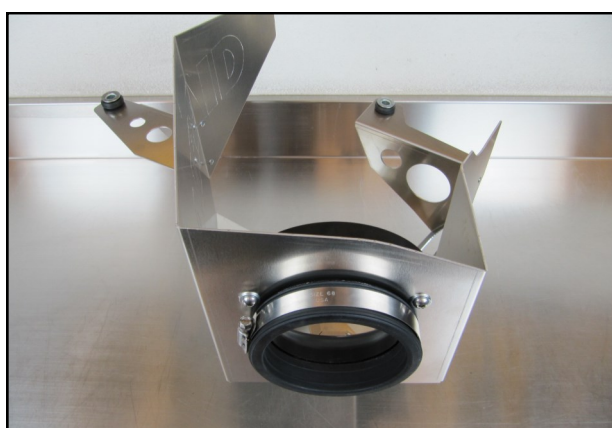

**8. Install the Adapter Coupler and Clamp onto the Filter Adapter.**

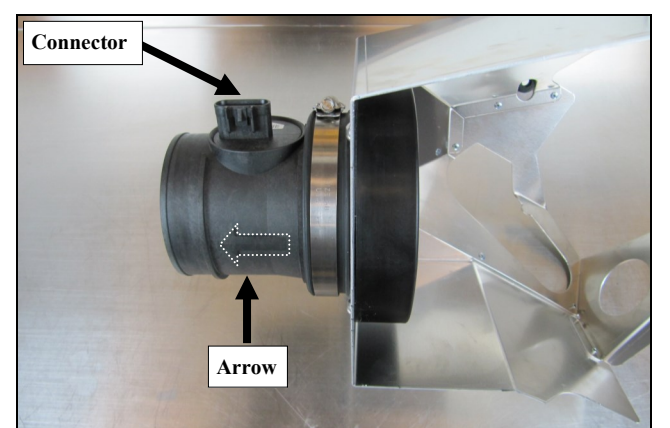

**9. Transfer the Mass Air Flow meter into the Coupler as shown. Note the location of the connector and direction indicating arrow. Do not tighten the Clamp at this time.**



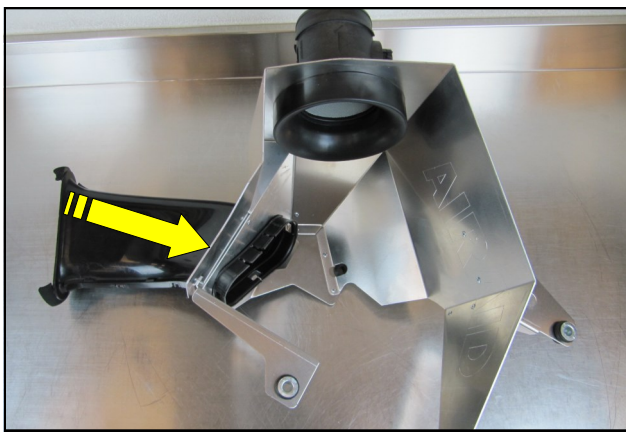

10. Transfer the factory air box scoop into the Air Dam assembly as shown. When properly installed, a distinct snap will sound indicating that it has locked firmly in place.

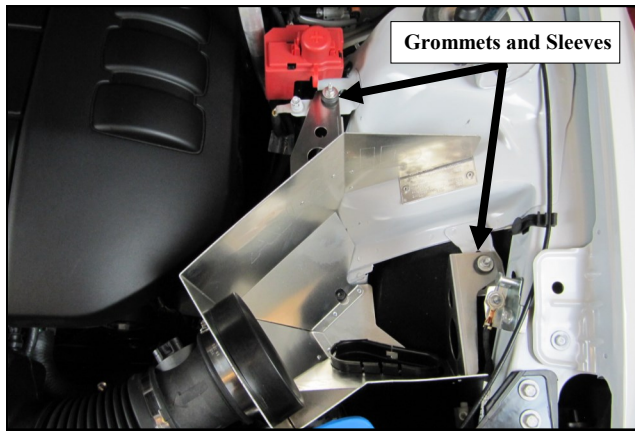

11. Install the Air Dam assembly into the inner fender area of the vehicle in the same manner as the OEM air-box. The grommets and sleeves are to be secured to the inner fender by re using the 6mm nuts that were removed in step Three.

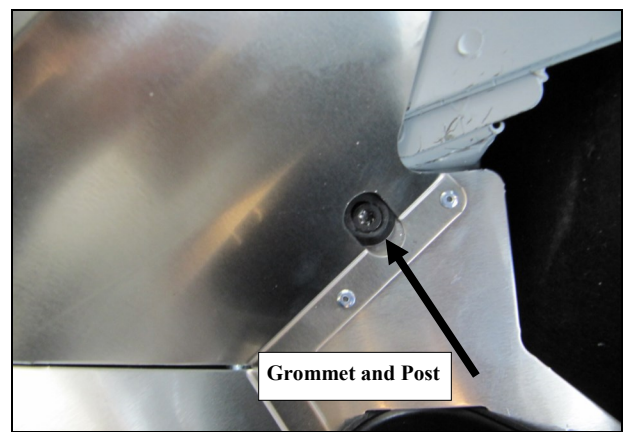

12. The bottom of the Air Dam assembly is to be secured using the grommet and post. Re connect the intake tube to the Mass Air Flow meter and reinstall the battery post cover.

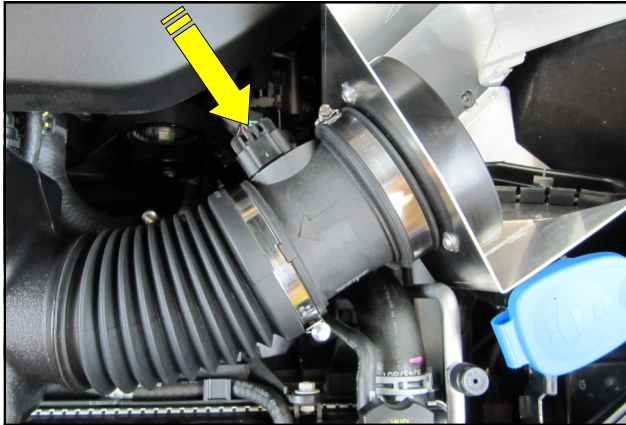

13. Check the positioning of the Mass Air Flow meter in relation to the wire harness. Readjust if necessary and tighten the clamps. Reconnect the Air Flow meter.



14. Install the Airaid Premium Filter on to the Filter Adapter.



15. Install the Weatherstrip onto the top edge of the Air Dam with the contour rolling away from the Filter.

### Double check your work!

Make sure there is no foreign material in the intake path. Make sure all clamps, hoses, bolts, and screws are tight. Double check the hood clearance!

### Reconnect the negative battery cable!

Thank you for purchasing the Airaid Intake System. Contact Airaid @ (800) 498-6951 8:00 AM - 5:00 PM MST weekdays for questions regarding fit or instructions that are not clear to you. Your Airaid Intake System was carefully inspected and packaged. Check that no parts are missing, or were damaged during shipping. If any parts are missing, contact Airaid. The air filter element is protected from direct exposure to water and debris; care should be taken not to drive through deep water. WATER INGESTION IS THE DRIVERS RESPONSIBILITY! The air filter is reusable and should be cleaned periodically.

## FILTER IDENTIFICATION

700-469 Airaid Oiled Media  
702-469 Airaid SynthaMax Dry Media - Black

701-469 Airaid SynthaMax Dry Media - Red  
703-469 Airaid SynthaMax Dry Media - Blue

For your Oiled media filter  
we suggest using the AIRAID  
Filter Tune-Up Kit!

*SynthaMax*<sup>®</sup>

## Do Not Oil



P/N 790-551 Aerosol Spray  
P/N 790-550 Squeeze Spray



Synthamax Air Filters do not require oil. Service air filter as needed by cleaning with common non-petroleum all-purpose household cleaner and water. Simple Green<sup>®</sup>, Formula 409<sup>®</sup> or equivalent works great. Apply cleaner to outside of air filter and allow to soak. Then flush filter clean from the inside out with a garden hose and repeat steps if necessary. Do not apply high pressure water or air to clean filter. Allow filter to air dry and reinstall.